

MINNESOTA DEPARTMENT OF TRANSPORTATION LYON COUNTY

MN PROJ NO: HSIP 4217 (237)

GOVERNING SPECIFICATIONS
THE 2016 EDITION OF THE MINNESOTA DEPARTMENT OF TRANSPORTATION
"STANDARD SPECIFICATION FOR CONSTRUCTION" SHALL GOVERN.

CONSTRUCTION PLAN FOR: CHEVRON SIGN INSTALLATION

LOCATED ON: C.R. 51, C.R. 54, C.R. 59, C.R. 62, C.R. 63, C.R. 66,
C.R. 67, C.R. 69, & C.R. 74.

STATE PROJECT NO. : 042-070-009

INDEX

| | |
|-------------|---|
| SHEET NO. 1 | TITLE SHEET |
| SHEET NO. 2 | ESTIMATED QUANTITIES, TYPICAL SECTIONS, AND CONSTRUCTION NOTES |
| SHEET NO. 3 | LOCATION MAP |

THIS PLAN CONTAINS 3 SHEETS

I HEREBY CERTIFY THAT THIS PLAN WAS PREPARED BY ME OR UNDER MY DIRECT SUPERVISION AND THAT I AM A DULY LICENSED PROFESSIONAL ENGINEER UNDER THE LAWS OF THE STATE OF MINNESOTA.

Aaron VanMoer TYPED OR
DESIGN ENGINEER PRINTED NAME: Aaron VanMoer

DATE 4/16/17 LICENSE NUMBER: 50428

Aaron VanMoer DATE: 4/18/17
APPROVED: LYON COUNTY ENGINEER

STATE AID APPROVALS:

Tom D. Bennett DATE 4/19/17
DISTRICT STATE-AID ENGINEER:
REVIEWED FOR COMPLIANCE WITH STATE AND/OR FEDERAL AID RULES/POLICY

Merry Dahn DATE 5/9/17
STATE-AID ENGINEER:
APPROVED FOR STATE AID AND/OR FEDERAL AID FUNDING

STATE PROJECT NO. 042-070-009

SHEET 1 OF 3 SHEETS

PROJECT LOCATIONS

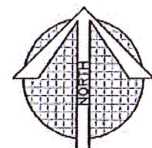

MAP NOT TO SCALE

LYON COUNTY

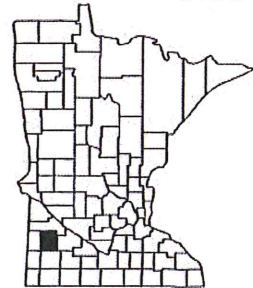

MINNESOTA

THE SUBSURFACE UTILITY INFORMATION IN THIS PLAN IS UTILITY QUALITY LEVEL "D". THIS UTILITY QUALITY WAS DETERMINED ACCORDING TO THE GUIDELINES OF CI/ASCE 38-02, ENTITLED "STANDARD GUIDELINES FOR THE COLLECTION AND DEPICTION OF EXISTING SUBSURFACE UTILITY DATA."

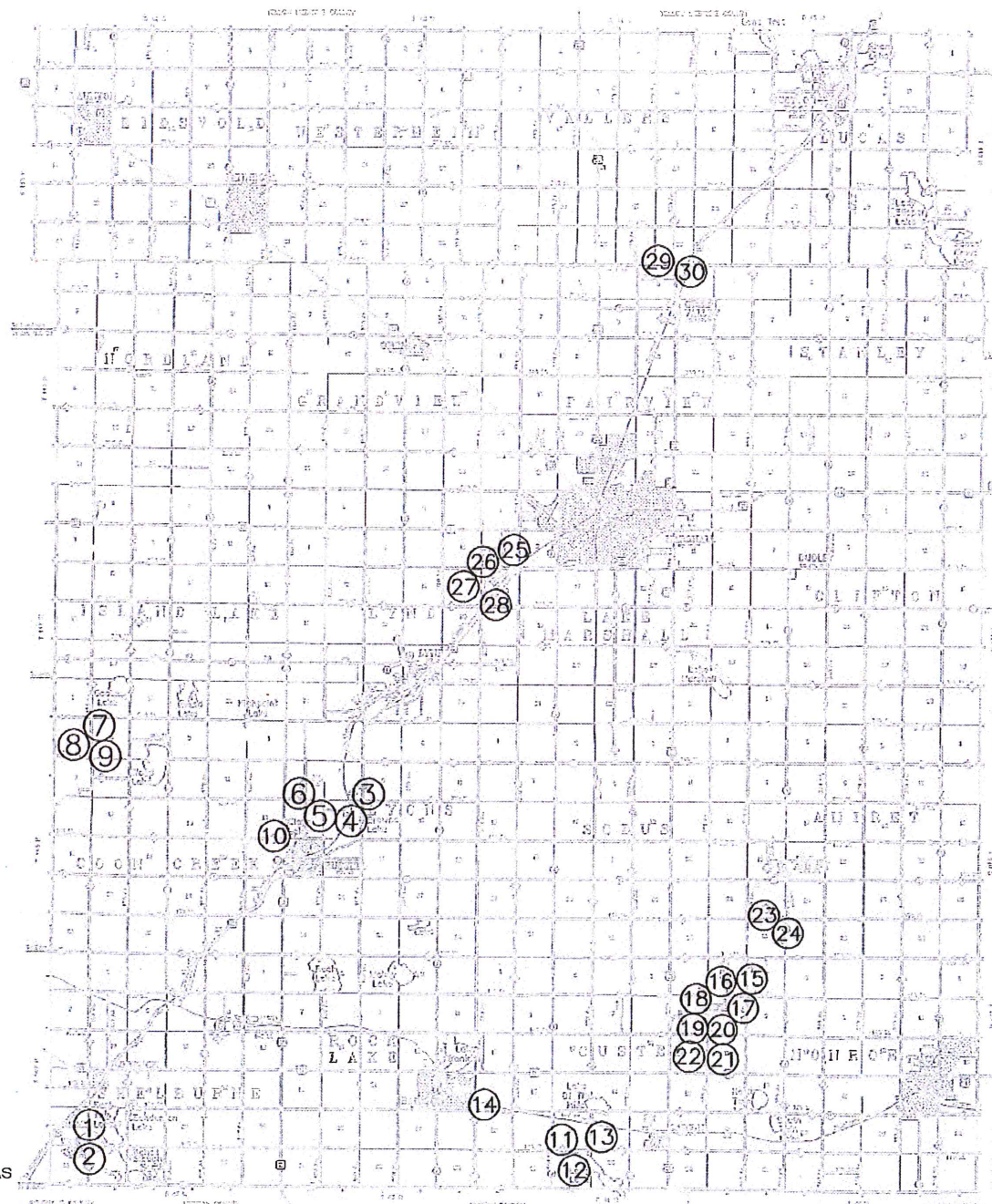

| ESTIMATED QUANTITIES | | | | | |
|----------------------|----------|---------------------------------|-------|--------------------------------|--------|
| NOTES | ITEM NO. | ITEM | UNIT | PARTICIPATING S.P. 042-070-009 | TOTAL |
| 3 | 2104.509 | REMOVE SIGN TYPE SPECIAL | EACH | 12.00 | 12.00 |
| 1 | 2564.533 | FURNISH SIGN PANELS TYPE C | SQ FT | 684.00 | 684.00 |
| 2,4,5 | 2564.536 | INSTALL SIGN PANEL TYPE SPECIAL | EACH | 114.00 | 114.00 |
| | | | | | |
| | | | | | |

CONSTRUCTION NOTES (ITEM SPECIFIC)

- PROVIDE SIGNS IN ACCORDANCE WITH THE PROVISIONS OF MnDOT 2016 STANDARD SPECIFICATIONS FOR CONSTRUCTION.
- INSTALL SIGN SUPPORTS TO MINIMUM HEIGHTS AND LATERAL DIMENSIONS AS PER MnMUTCD RURAL AREA ROADWAY SIGN (FIGURE 2A-2). SEE DETAILS. TRAFFIC CONTROL SHALL BE INCIDENTAL AND INCLUDED WITH THE TOTAL BID PRICE. ALL TRAFFIC CONTROL DEVICES SHALL CONFORM TO THE MOST RECENT EDITION OF THE MINNESOTA MANUAL ON UNIFORM TRAFFIC CONTROL DEVICES, INCLUDING "FIELD MANUAL FOR TEMPORARY TRAFFIC CONTROL ZONE LAYOUTS."
- REMOVED SIGNS ASSEMBLIES MUST BE COMPLETELY REMOVED, INCLUDING THE ENTIRE ANCHOR. REMOVED SIGN ASSEMBLY SHALL BECOME PROPERTY OF THE CONTRACTOR.
- LYON COUNTY SHALL MARK EACH SIGN LOCATION PRIOR TO INSTALLATION. THE CONTRACTOR SHALL BE RESPONSIBLE FOR THE GOPHER ONE CALL LOCATE PRIOR TO PLACEMENT.
- ALL POSTS AND HARDWARE SHALL BE TELES PAR BRAND.

CONSTRUCTION NOTES (GENERAL)

- ALL CONSTRUCTION COVERED BY RIGHT OF WAY OR EASEMENT.
- THE SUBSURFACE UTILITY INFORMATION IN THIS PLAN IS UTILITY QUALITY LEVEL "D". THIS UTILITY QUALITY WAS DETERMINED ACCORDING TO THE GUIDELINES OF CI/ASCE 38-02, ENTITLED "STANDARD GUIDELINES FOR THE COLLECTION AND DEPICTION OF EXISTING SUBSURFACE UTILITY DATA."

TYPICAL SECTION
Height and Lateral Location of Rural Roadside Signs

NOT TO SCALE

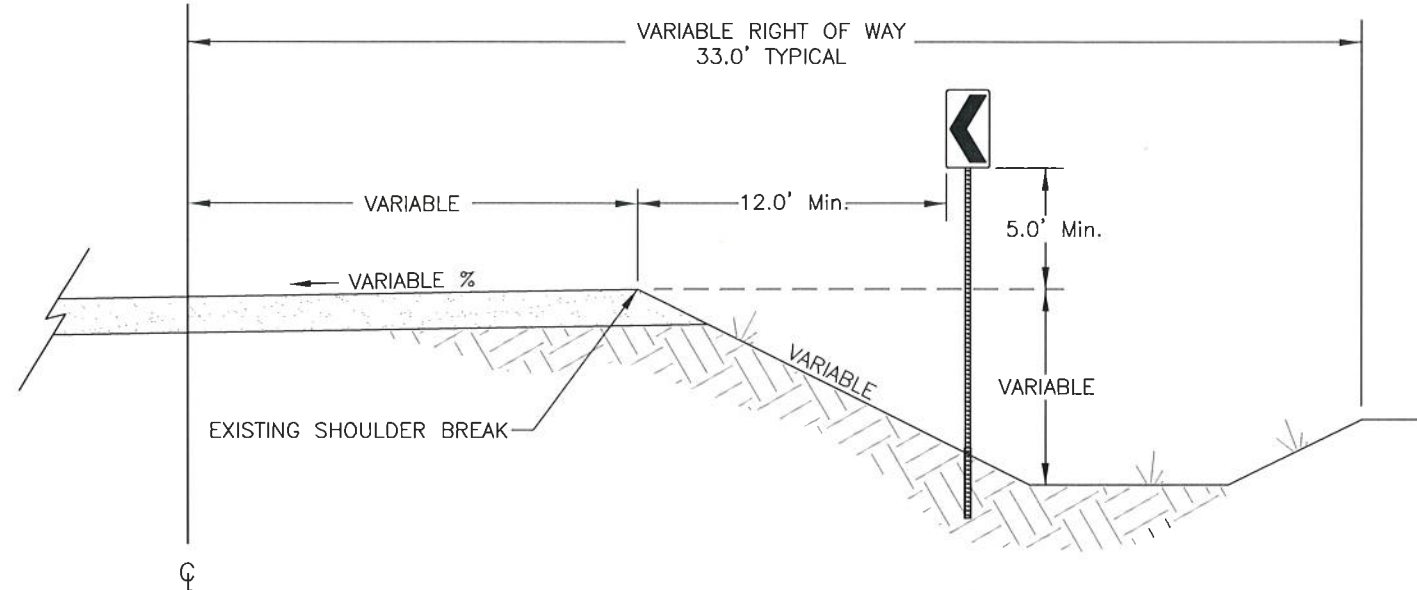

STANDARD PLATES

THE FOLLOWING STANDARD PLATES, APPROVED BY FHWA, SHALL APPLY ON THIS PROJECT

8000 J - CHANNILIZERS

Sign Installation - Sign Panel Type Special (2564.536)
Single Breakaway Anchor

Typical all location

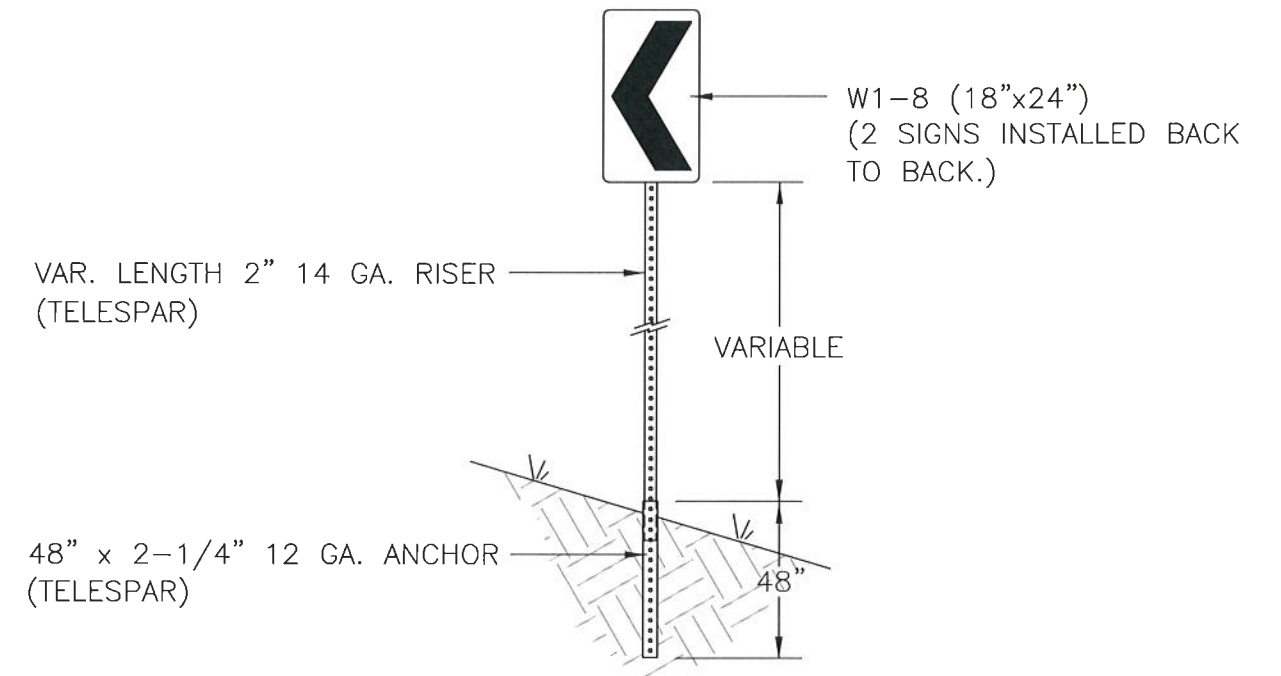

SIGN INSTALLATION NOTES:

- ALL SQUARE POSTS SHALL BE GALVANIZED AND PRE-PUNCHED.
- STAINLESS BOLTS, WASHERS, AND NYLON LOCK NUTS REQUIRED. USE NYLON WASHERS AGAINST SIGN SHEETING.
- INSTALL ANCHOR INTO THE GROUND LEAVING 1" TO 2" ABOVE THE EXISTING SURFACE. INSTALL THE SIGN POST 6" TO 8" INTO THE ANCHOR.
- TOTAL BID PRICE FOR 2564.536 "INSTALL SIGN PANEL TYPE SPECIAL" SHALL INCLUDE ALL MATERIALS AND LABOR TO INSTALL ANCHOR, RISER, AND SIGNS.
- ALL POST MATERIALS AND HARDWARE MUST BE TELES PAR BRAND.

CERTIFIED BY

[Signature]
LICENSED PROFESSIONAL ENGINEER

LIC. NO. 50428

DATE 4/13/17

STATE PROJECT NO. 042-070-009

SHEET 2 OF 3 SHEETS

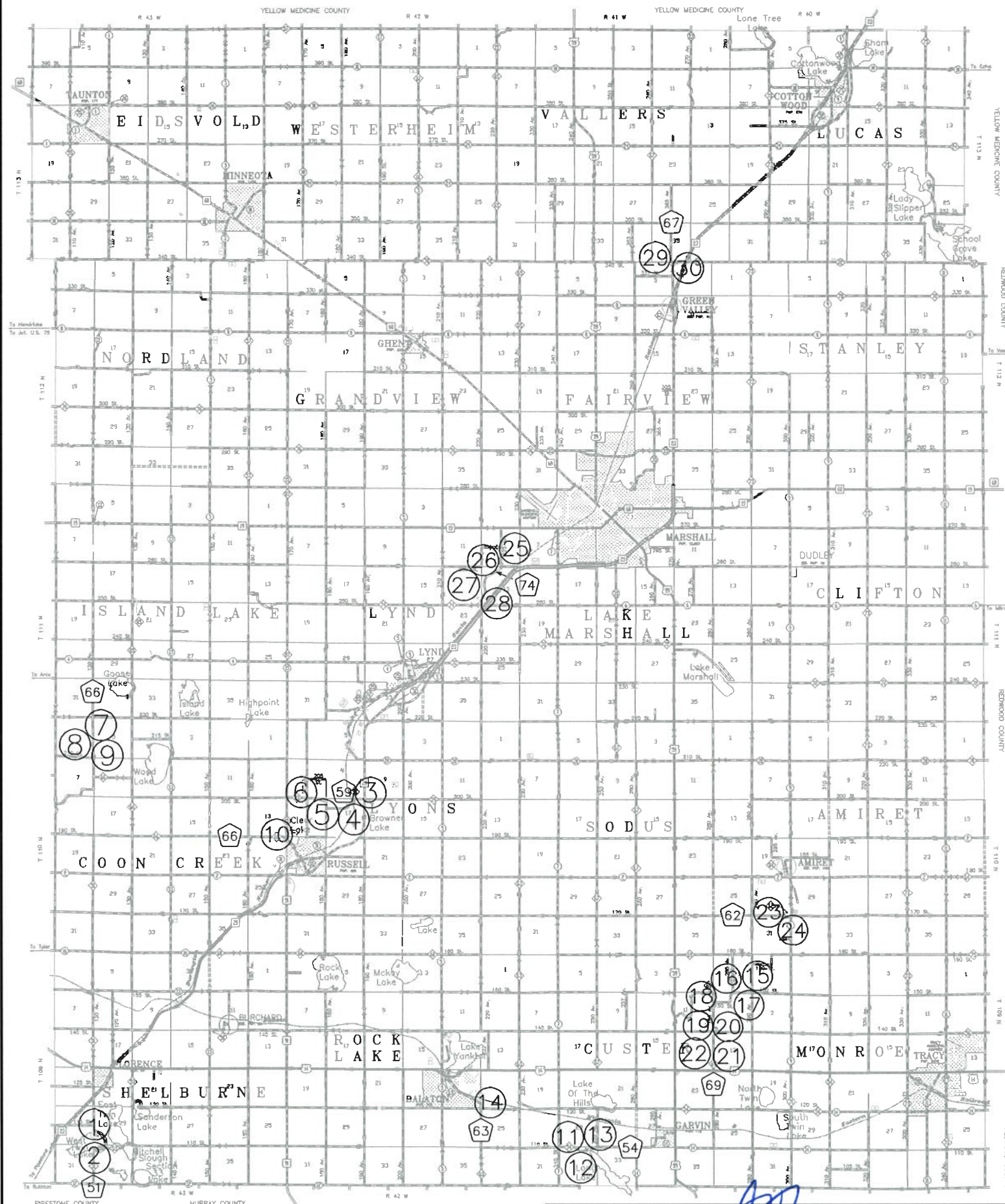

SIGN ASSEMBLY LOCATION TAB

| ROUTE | CURVE IDENTIFIER | CURVE RADIUS | ASSEMBLIES REQUIRED | CHEVRON SPACING | REMOVE |
|-------|------------------|--------------|---------------------|-----------------|--------|
| CR 51 | 1 | 225' | 4 | 80' | 0 |
| CR 51 | 2 | 250' | 6 | 80' | 0 |
| CR 59 | 3 | 900' | 3 | 160' | 0 |
| CR 59 | 4 | 600' | 4 | 120' | 0 |
| CR 59 | 5 | 900' | 3 | 160' | 0 |
| CR 59 | 6 | 600' | 4 | 120' | 0 |
| CR 66 | 7 | 700' | 2 | 160' | 0 |
| CR 66 | 8 | 450' | 3 | 120' | 0 |
| CR 66 | 9 | 700' | 2 | 160' | 0 |
| CR 66 | 10 | 750' | 4 | 160' | 0 |
| CR 54 | 11 | 600' | 4 | 120' | 0 |
| CR 54 | 12 | 750' | 4 | 160' | 4 |
| CR 54 | 13 | 1000' | 3 | 160' | 3 |
| CR 63 | 14 | 627' | 6 | 120' | 0 |
| CR 69 | 15 | 250' | 3 | 80' | 0 |
| CR 69 | 16 | 200' | 4 | 40' | 0 |
| CR 69 | 17 | 215' | 5 | 80' | 0 |
| CR 69 | 18 | 215' | 5 | 80' | 3 |
| CR 69 | 19 | 215' | 4 | 80' | 0 |
| CR 69 | 20 | 190' | 6 | 40' | 0 |
| CR 69 | 21 | 200' | 4 | 80' | 0 |
| CR 69 | 22 | 190' | 7 | 40' | 0 |
| CR 62 | 23 | 400' | 3 | 80' | 0 |
| CR 62 | 24 | 300' | 4 | 80' | 0 |
| CR 74 | 25 | 200' | 3 | 80' | 2 |
| CR 74 | 26 | 325' | 3 | 80' | 0 |
| CR 74 | 27 | 500' | 2 | 120' | 0 |
| CR 74 | 28 | 500' | 3 | 120' | 0 |
| CR 67 | 29 | 250' | 3 | 80' | 0 |
| CR 67 | 30 | 300' | 3 | 80' | 0 |
| TOTAL | | | 114 | | 12 |

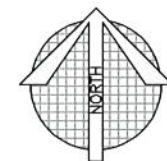

MAP NOT TO SCALE

LEGEND

CURVE LOCATION

CERTIFIED BY APM
 LICENSED PROFESSIONAL ENGINEER

LIC. NO. 50428 DATE 4/3/17

STATE PROJECT NO. 042-070-009

SHEET 3 OF 3 SHEETS